

## 6. Carbon Steel

### Characteristic

1. Providing the max length: 3m.
2. Hardness of the ball runner rail surface : HRC 58 ~ 63  
Hardness of the centre : About HRC 28
3. Applies to the industrial machine in normal condition.
4. Sizes are the same as stainless steel products.
5. With more competitive price.
6. Precision class available for N, H, and P Grade.
7. Product size, precision class, and other technical information are the same as MR stainless series, please refer to **cpc** MR Miniature Linear Guide Series Catalog.

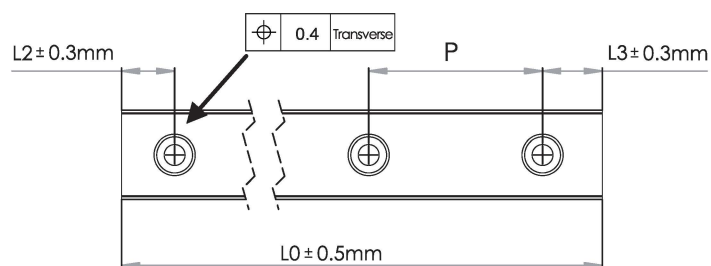
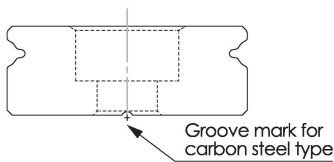

Suggestion length of one rail	Standard			Wide		
	9M	12M	15M	9W	12W	15W
Pitch(mm)	20	25	40	30	40	40
L2, L3 min	4	4	4	4	4	4
L2, L3 max	20	20	35	25	35	35
Lmax L0 (mm)	3000	3000	3000	3000	3000	3000

**MR**

MINIATURE LINEAR GUIDE SERIES

## 6. Carbon Steel

### Standard Rail

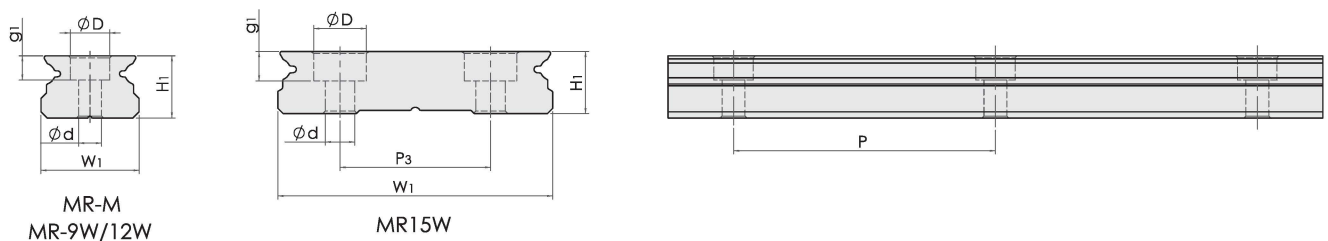

MR-M  
MR-9W/12W

MR15W

#### Standard MR-M series Rail

Model Code	Rail Dimensions(mm)				Weight(g/m)
	H1	W1	P	Dxdxg1	
MR 15M	9.5	15	40	6x3.5x4.5	930
MR 12M	7.5	12	25	6x3.5x4.5	602
MR 9M	5.5	9	20	6x3.5x3.5	301

#### Wide MR-W series Rail

Model Code	Rail Dimensions(mm)					Weight(g/m)
	H1	W1	P	P3	Dxdxg1	
MR 15W	9.5	42	40	23	8x4.5x4.5	2818
MR 12W	8.5	24	40	-	8x4.5x4.5	1472
MR 9W	7.3	18	30	-	6x3.5x4.5	940

### Tapped Rail

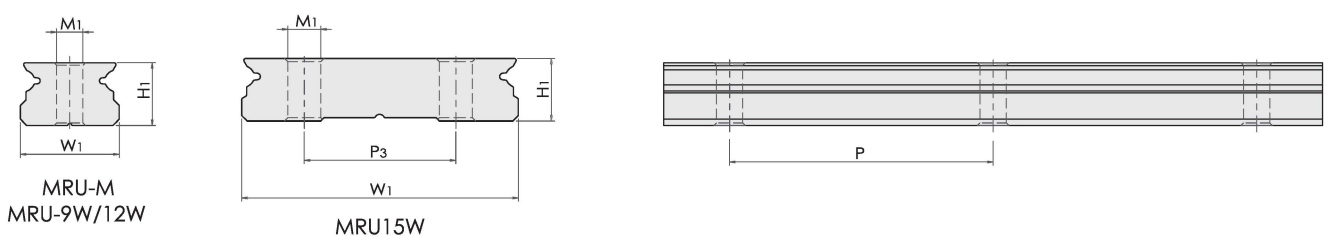

MRU-M  
MRU-9W/12W

MRU15W

#### Standard MRU-M series - Tapped from bottom

Model Code	Rail Dimensions(mm)				Weight(g/m)
	H1	W1	P	M1	
MRU 15M	9.5	15	40	M4x0.7	930
MRU 12M	7.5	12	25	M4x0.7	602
MRU 9M	5.5	9	20	M4x0.7	301

#### Wide MRU-W series - Tapped from bottom

Model Code	Rail Dimensions(mm)					Weight(g/m)
	H1	W1	P	P3	M1	
MRU 15W	9.5	42	40	23	M5x0.8	2818
MRU 12W	8.5	24	40	-	M5x0.8	1472
MRU 9W	7.3	18	30	-	M4x0.7	940